

INNOVATIONS  
**MASTER CATALOG**

**TOOLING SYSTEMS**  
2013



[www.kennametal.com](http://www.kennametal.com)

 **KENNAMETAL®**

**GENERAL ENGINEERING**

**TRANSPORTATION**



**AEROSPACE & DEFENSE**

**EARTHWORKS**

**ENERGY**

 **KENNAMETAL®**

# Collets and Sleeves

TG150 Series



- Provides Tremendous Grip (3:1 advantage) and accuracy for all drilling applications.
- Industry-standard Erickson™ single-angle collet system.
- 0,4mm [.016" (1/64")] range of collapse.
- Grips on back taper and margin of drill for maximum feed rates and more accurate holes.
- Manufactured to DIN 6499 Class 2 accuracy; see page M103.

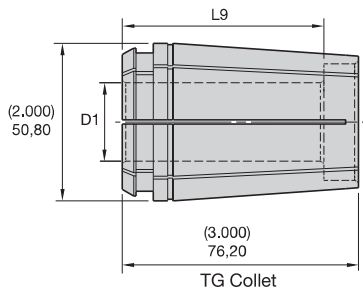

TG Collet

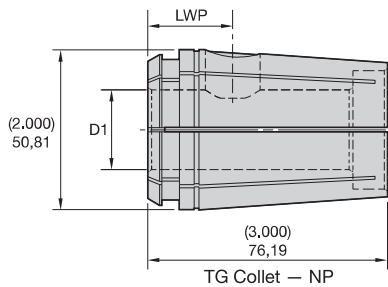

TG Collet - NP

## ERICKSON

### TG150 Series • Metric

D1	150TG standard	150TGNP standard – non-pullout	collet capacity max mm	collet capacity min mm	L9	LWP
12,0	150TG120M	–	12,0	11,6	44,0	–
13,0	150TG130M	–	13,0	12,6	44,0	–
14,0	150TG140M	–	14,0	13,6	44,0	–
14,5	150TG145M	–	14,5	14,1	44,0	–
15,0	150TG150M	–	15,0	14,6	54,0	–
16,0	150TG160M	–	16,0	15,6	54,0	–
18,0	150TG180M	–	18,0	17,6	54,0	–
19,0	150TG190M	–	19,0	18,6	76,2	–
20,0	150TG200M	–	20,0	19,6	76,2	–
21,0	150TG210M	–	21,0	20,6	76,2	–

(continued)

(TG150 Series continued)

D1	150TG standard	150TGNP standard – non-pullout	collet capacity max mm	collet capacity min mm	L9	LWP
22,0	150TG220M	–	22,0	21,6	76,2	–
25,0	150TG250M	–	25,0	24,6	76,2	–
25,0	–	150TGNP250M	25,0	–	–	22
25,5	150TG255M	–	25,5	25,1	76,2	–
26,0	150TG260M	–	26,0	25,6	76,2	–
27,0	150TG270M	–	27,0	26,6	76,2	–
28,0	150TG280M	–	28,0	27,6	76,2	–
30,0	150TG300M	–	30,0	29,6	76,2	–
32,0	150TG320M	–	32,0	31,6	76,2	–
32,0	–	150TGNP320M	32,0	–	–	22
34,0	150TG340M	–	34,0	33,6	76,2	–
35,0	150TG350M	–	35,0	34,6	76,2	–
36,0	150TG360M	–	36,0	35,6	76,2	–
38,0	150TG380M	–	38,0	37,6	76,2	–
40,0	150TG400M	–	40,0	39,6	76,2	–

NOTE: Inserting the cutting tool less than 2/3 of the gripping length into the collet can influence the coolant sealing performance and permanently damage the collet.  
 Full length of the gripping bore needs to be maintained to achieve maximum accuracy and safety.  
 Collet accuracies are based on size-for-size conditions. Using the collapsible range can influence the accuracy and gripping powers.  
 Never try to stretch the collets by clamping oversized cutting tools.

# Collets and Sleeves

TG150 Series



- Provides Tremendous Grip (3:1 advantage) and accuracy for all drilling applications.
- Industry-standard Erickson™ single-angle collet system.
- 150TG 0,4mm [.016" (1/64)] range of collapse.
- 150TGCHP and 150TGNP 0,13mm (.005") range of collapse.
- Grips on back taper and margin of drill for maximum feed rates and more accurate holes.
- Manufactured to DIN 6499 Class 2 accuracy; see page M103.
- HP design manufactured to DIN 6499 class/accuracy.

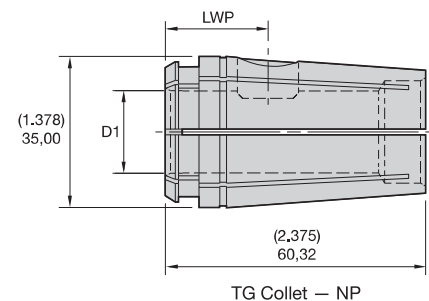
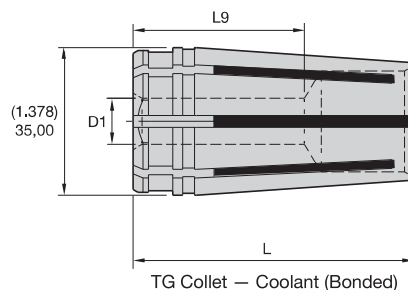
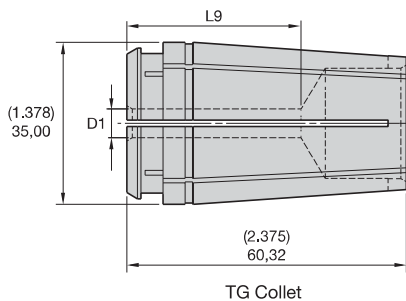

TG Collet



TG Collet – Coolant (Bonded)



TG Collet – NP

**ERICKSON™**

■ TG150 Series • Inch

D1	150TG standard	150TGCHP high precision – coolant	150TGNP milling – non-pullout	collet capacity max inch	collet capacity min inch	L9	LWP
3/8	150TG0375	–	–	.3750	.3594	2.000	–
25/64	150TG0391	–	–	.3906	.3750	2.000	–
13/32	150TG0406	–	–	.4063	.3906	2.000	–
27/64	150TG0422	–	–	.4219	.4063	2.000	–
7/16	150TG0438	–	–	.4375	.4219	2.000	–
29/64	150TG0453	–	–	.4531	.4375	2.000	–
15/32	150TG0468	–	–	.4688	.4531	2.000	–
31/64	150TG0484	–	–	.4844	.4688	2.000	–
1/2	150TG0500	–	–	.5000	.4844	2.560	–
1/2	–	–	150TGNP0500	.5000	–	–	.828
33/64	150TG0516	–	–	.5156	.5000	2.560	–
17/32	150TG0531	–	–	.5313	.5156	2.560	–

(continued)





(TG150 Series continued)

D1	150TG standard	150TGCHP high precision – coolant	150TGNP milling – non-pullout	collet capacity max inch	collet capacity min inch	L9	LWP
35/64	150TG0547	—	—	.5469	.5313	2.560	—
9/16	150TG0562	—	—	.5625	.5469	2.560	—
37/64	150TG0578	—	—	.5781	.5625	2.560	—
19/32	150TG0594	—	—	.5938	.5781	2.560	—
39/64	150TG0609	—	—	.6094	.5938	2.560	—
5/8	150TG0625	—	—	.6250	.6094	2.560	—
5/8	—	—	150TGNP0625	.6250	—	—	.875
41/64	150TG0641	—	—	.6406	.6250	2.560	—
21/32	150TG0656	—	—	.6563	.6406	2.560	—
43/64	150TG0672	—	—	.6719	.6563	2.560	—
11/16	150TG0688	—	—	.6875	.6719	2.560	—
45/64	150TG0703	—	—	.7031	.6875	2.560	—
23/32	150TG0719	—	—	.7188	.7031	2.560	—
47/64	150TG0734	—	—	.7344	.7188	2.560	—
3/4	150TG0750	—	—	.7500	.7344	2.560	—
3/4	—	—	150TGNP0750	.7500	—	—	.938
49/64	150TG0766	—	—	.7656	.7500	2.560	—
25/32	150TG0781	—	—	.7813	.7656	2.560	—
51/64	150TG0797	—	—	.7969	.7813	2.560	—
13/16	150TG0812	—	—	.8125	.7969	2.560	—
53/64	150TG0828	—	—	.8281	.8125	2.560	—
27/32	150TG0844	—	—	.8438	.8281	2.560	—
55/64	150TG0859	—	—	.8594	.8438	2.560	—
7/8	150TG0875	—	—	.8750	.8594	2.560	—
7/8	—	—	150TGNP0875	.8750	—	—	.938
57/64	150TG0891	—	—	.8906	.8750	2.560	—
29/32	150TG0906	—	—	.9063	.8906	2.560	—
59/64	150TG0922	—	—	.9219	.9063	2.560	—
15/16	150TG0938	—	—	.9375	.9219	2.560	—
61/64	150TG0953	—	—	.9531	.9375	2.560	—
31/32	150TG0969	—	—	.9688	.9531	2.560	—
63/64	150TG0984	—	—	.9844	.9688	2.560	—
1	150TG1000	—	—	1.0000	.9844	2.560	—
1	—	150TGCHP1000	—	—	—	—	—
1	—	—	150TGNP1000	1.0000	—	—	1.063
1 1/64	150TG1016	—	—	1.0156	1.0000	2.560	—
1 1/32	150TG1031	—	—	1.0313	1.0156	2.560	—
1 3/64	150TG1047	—	—	1.0469	1.0313	2.560	—
1 1/16	150TG1062	—	—	1.0625	1.0469	2.560	—
1 5/64	150TG1078	—	—	1.0781	1.0625	2.560	—
1 3/32	150TG1094	—	—	1.0938	1.0781	2.560	—
1 7/64	150TG1109	—	—	1.1094	1.0938	2.560	—
1 9/64	150TG1141	—	—	1.1200	1.1094	2.560	—
1 1/8	150TG1125	—	—	1.1250	1.1200	2.560	—
1 5/32	150TG1156	—	—	1.1563	1.1250	2.560	—
1 11/64	150TG1172	—	—	1.1719	1.1563	2.560	—
1 3/16	150TG1187	—	—	1.1875	1.1719	2.560	—
1 13/64	150TG1203	—	—	1.2031	1.1875	2.560	—

(continued)

Collets and Sleeves

# Collets and Sleeves

## TG150 Series



(TG150 Series continued)

D1	150TG standard	150TGCHP high precision – coolant	150TGNP milling – non-pullout	collet capacity max inch	collet capacity min inch	L9	LWP
1 7/32	150TG1219	–	–	1.2188	1.2031	2.560	–
1 15/64	150TG1234	–	–	1.2344	1.2188	2.560	–
1 1/4	150TG1250	–	–	1.2500	1.2344	2.560	–
1 1/4	–	–	150TGNP1250	1.2500	–	–	1.063
1 1/4	–	150TGCHP1250	–	–	–	–	–
1 17/64	150TG1266	–	–	1.2656	1.2500	2.560	–
1 9/32	150TG1281	–	–	1.2813	1.2656	2.560	–
1 19/64	150TG1297	–	–	1.2969	1.2813	2.560	–
1 5/16	150TG1312	–	–	1.3125	1.2969	2.560	–
1 21/64	150TG1328	–	–	1.3281	1.3125	2.560	–
1 11/32	150TG1344	–	–	1.3438	1.3281	2.560	–
1 23/64	150TG1359	–	–	1.3594	1.3438	2.560	–
1 3/8	150TG1375	–	–	1.3750	1.3594	2.560	–
1 25/64	150TG1391	–	–	1.3906	1.3750	2.560	–
1 13/32	150TG1406	–	–	1.4063	1.3906	2.560	–
1 27/64	150TG1422	–	–	1.4219	1.4063	2.560	–
1 7/16	150TG1438	–	–	1.4375	1.4219	2.560	–
1 29/64	150TG1453	–	–	1.4531	1.4375	2.560	–
1 15/32	150TG1469	–	–	1.4688	1.4531	2.560	–
1 1/2	150TG1500	–	–	1.5000	1.4688	2.560	–
1 1/2	–	–	150TGNP1500	1.5000	–	–	1.063
1 1/2	–	150TGCHP1500	–	–	–	–	–
1 31/32	150TG1484	–	–	1.9688	1.5000	2.560	–

NOTE: Inserting the cutting tool less than 2/3 of the gripping length into the collet can influence the coolant sealing performance and permanently damage the collet.  
 Full length of the gripping bore needs to be maintained to achieve maximum accuracy and safety.  
 Collet accuracies are based on size-for-size conditions. Using the collapsible range can influence the accuracy and gripping powers.  
 Never try to stretch the collets by clamping oversized cutting tools.



- An economical way to purchase a group of collets.

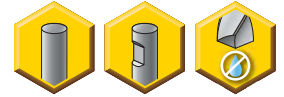

TG Collet

### ERICKSON

#### ■ TG150 Collet Set • Metric

catalog number	series	quantity	dimensional range	incremental division
150TGS000M	TG150	3	25mm - 40mm	25 & 32 & 40

#### ■ TG150 Collet Set • Inch

catalog number	series	quantity	dimensional range	incremental division
S150TG1SET	TG150	65	1/2 - 1 1/2	1/64
S150TG2SET	TG150	33	1/2 - 1 1/2	1/32
S150TG4SET	TG150	25	3/4 - 1 1/2	1/32



TG Collet — NP

#### ■ TG150 NP-Out Collet Set • Inch

catalog number	series	quantity	dimensional range	incremental division
S150TGNPSET	TG150	7	1/2 - 1 1/2	1/8 (1/2-1) & 1/4 (1 1/4-1 1/2)

## Collets and Sleeves

### TG150 Single-Angle Solid Tap Collets



- Can be used in all standard TG collet chucks.
- Provides Tremendous Grip (3:1 advantage) and accuracy for tapping applications.
- Slot in back of collets acts as a drive for the tap square.
- Industry-standard Erickson™ single-angle collet system.

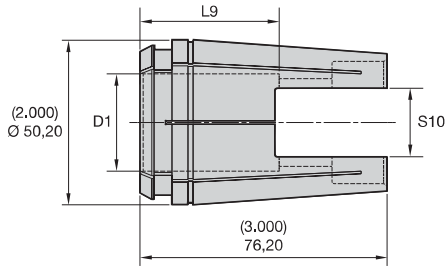

### ERICKSON™

#### ■ TG150 Solid Tap Collet • Metric DIN and ISO

\*\*\* Metric DIN and ISO only available in TG50 and TG100 series \*\*\*

#### ■ TG150 Solid Tap Collet • Inch/Metric ANSI

mm	tap size		150TGST solid tap	collet series	D1	S10	L9
	in						
—	3/4		150TGST075	TG150	.590	.442	1.213
—	1/2P		150TGST050P	TG150	.688	.515	.812
—	3/8P		150TGST037P	TG150	.700	.531	.812
M25	1		150TGST100	TG150	.800	.600	1.463
M27	1 1/16 & 1 1/8		150TGST112	TG150	.896	.672	1.650
—	3/4P		150TGST075P	TG150	.906	.679	.906
M30	1 3/16 & 1 1/4		150TGST125	TG150	1.021	.766	1.750
M33	1 5/16 & 1 3/8		150TGST137	TG150	1.108	.831	1.687
—	1P		150TGST100P	TG150	1.125	2.142	.906
M36	1 7/16 & 1 1/2		150TGST150	TG150	1.233	.925	1.625
M39	1 5/8		150TGST162	TG150	1.305	.979	1.625
—	1 1/4P		150TGST125P	TG150	1.313	2.085	.963
M42	1 3/4		150TGST175	TG150	1.430	1.072	1.500
—	1 1/2P		150TGST150P	TG150	1.500	1.898	1.150

NOTE: Inserting the cutting tool less than 2/3 of the gripping length into the collet can influence the coolant sealing performance and permanently damage the collet.  
Full length of the gripping bore needs to be maintained to achieve maximum accuracy and safety.  
Collet accuracies are based on size-for-size conditions. Using the collapsible range can influence the accuracy and gripping powers.  
Never try to stretch the collets by clamping oversized cutting tools.



# The Kennametal Solution

**Kennametal Global Engineered Solutions. Coordinated global resources with world-class manufacturing, process development, and implementation capabilities.**

**No matter how small or large your project.**

- Whether it's a single tailored tool or the development of a comprehensive manufacturing process, Kennametal's team can manage the development, personnel training, and successful implementation of the complete solution.

**Regardless of where you're located, Kennametal is everywhere you are.**

- With Kennametal's team, you receive globally coordinated manufacturing, process development, implementation, and optimization support and key alliances with machine tool builders and other leading technology manufacturers that ensure a complete solution.

Experience the advantages at your Authorized Kennametal Distributor or at [www.kennametal.com](http://www.kennametal.com).

[www.kennametal.com](http://www.kennametal.com)

